

VIEWPORT 1

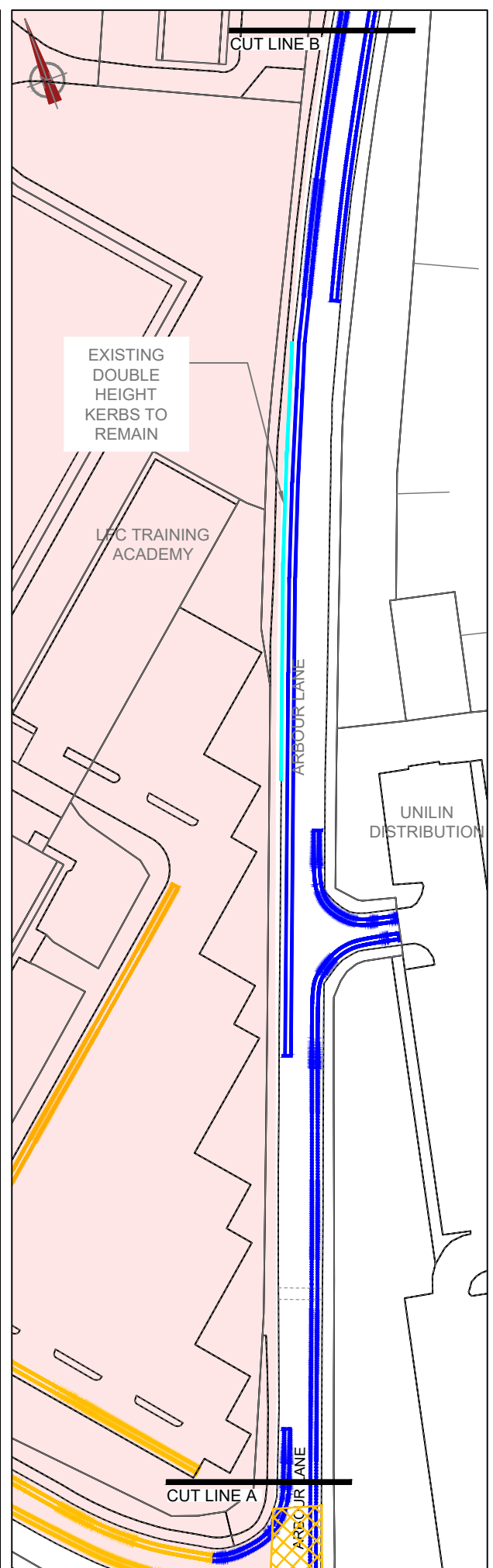

VIEWPORT 2

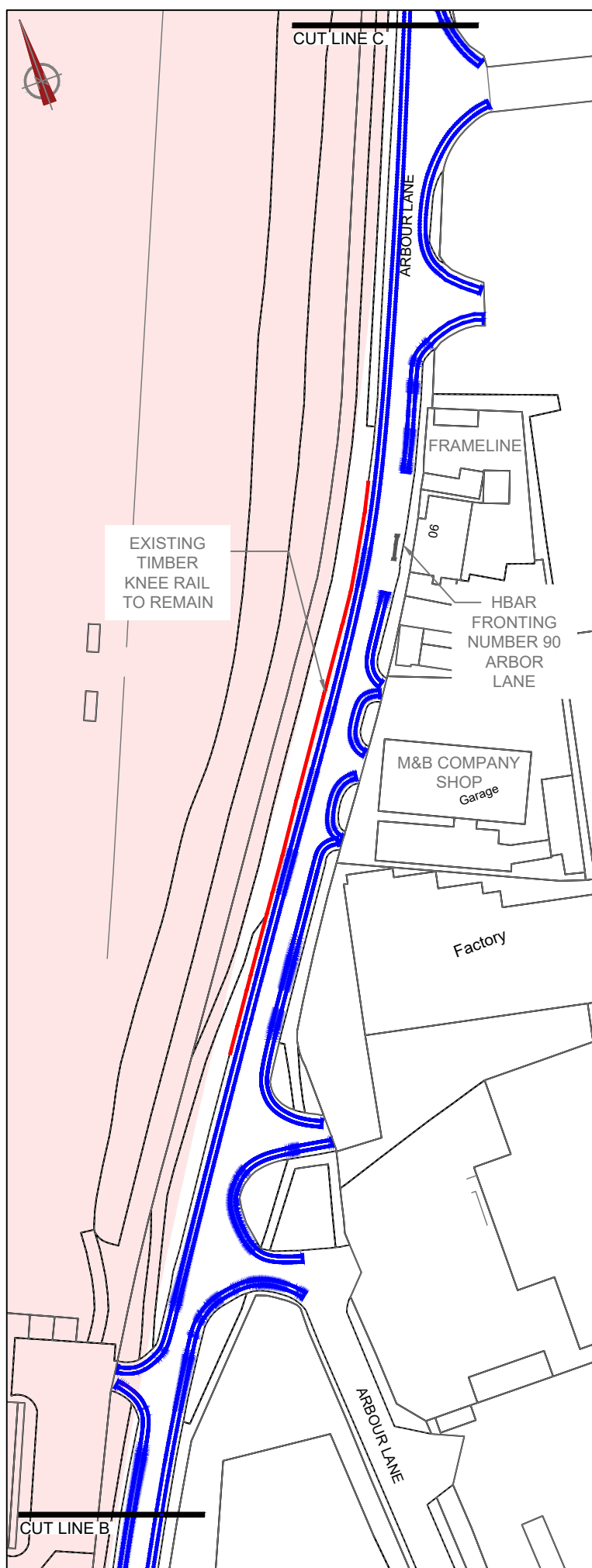

VIEWPORT 3

NOTES:

No reproductions without Authority
 Do not scale, use only figured dimensions.
 The contractor is to check all dimensions on site and report any discrepancies to the Project Manager or Site Supervisor.
 This drawing is to be read in conjunction with all other standard documentation.
 Ordnance Survey material produced with permission under Knowsley Metropolitan Borough Council Crown Copyright OS licence number 100022848, 2023.

KEY

	EXISTING DOUBLE YELLOW LINES (NO WAITING AT ANY TIME) TO REMAIN
	PROPOSED DOUBLE YELLOW LINES (NO WAITING AT ANY TIME)
	PROPOSED YELLOW BOX JUNCTION MARKING
	LFC TRAINING GROUND SITE EXTENTS
	EXISTING DOUBLE HEIGHT KERB
	EXISTING TIMBER KNEE RAIL

REV	DESCRIPTION	BY	DATE
STATUS: FOR CONSULTATION			



Knowsley Council

HIGHWAYS & CAPITAL DELIVERY NETWORK MANAGEMENT
 PO Box 21 | Archway Road | Huyton | L36 9YU
 www.knowsley.gov.uk

ARBOUR LANE, KIRKBY	
PROJECT NAME:	
PROPOSED WAITING RESTRICTIONS	
PROJECT NAME:	
PT/TM/7872/01	0
DRAWING NUMBER:	REV:

LT	CHECKED:	APPROVED:	1:1000
DRAWN:	DATE:	DATE:	
MAY 24	DATE:	DATE:	SCALE @A3:

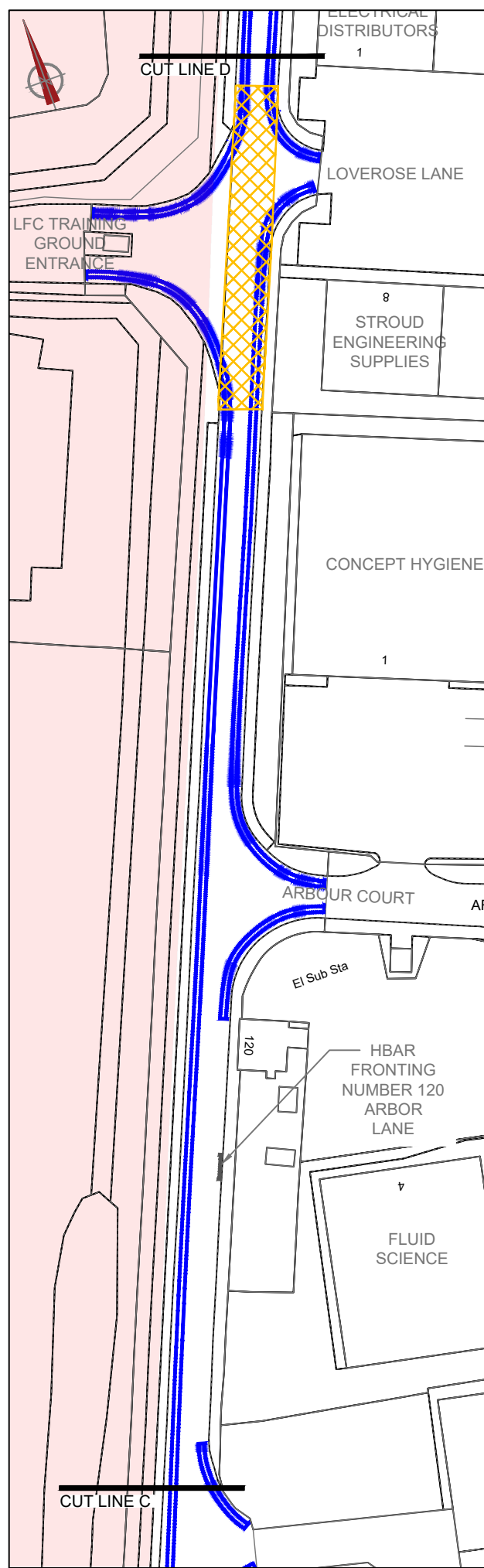

VIEWPORT 4

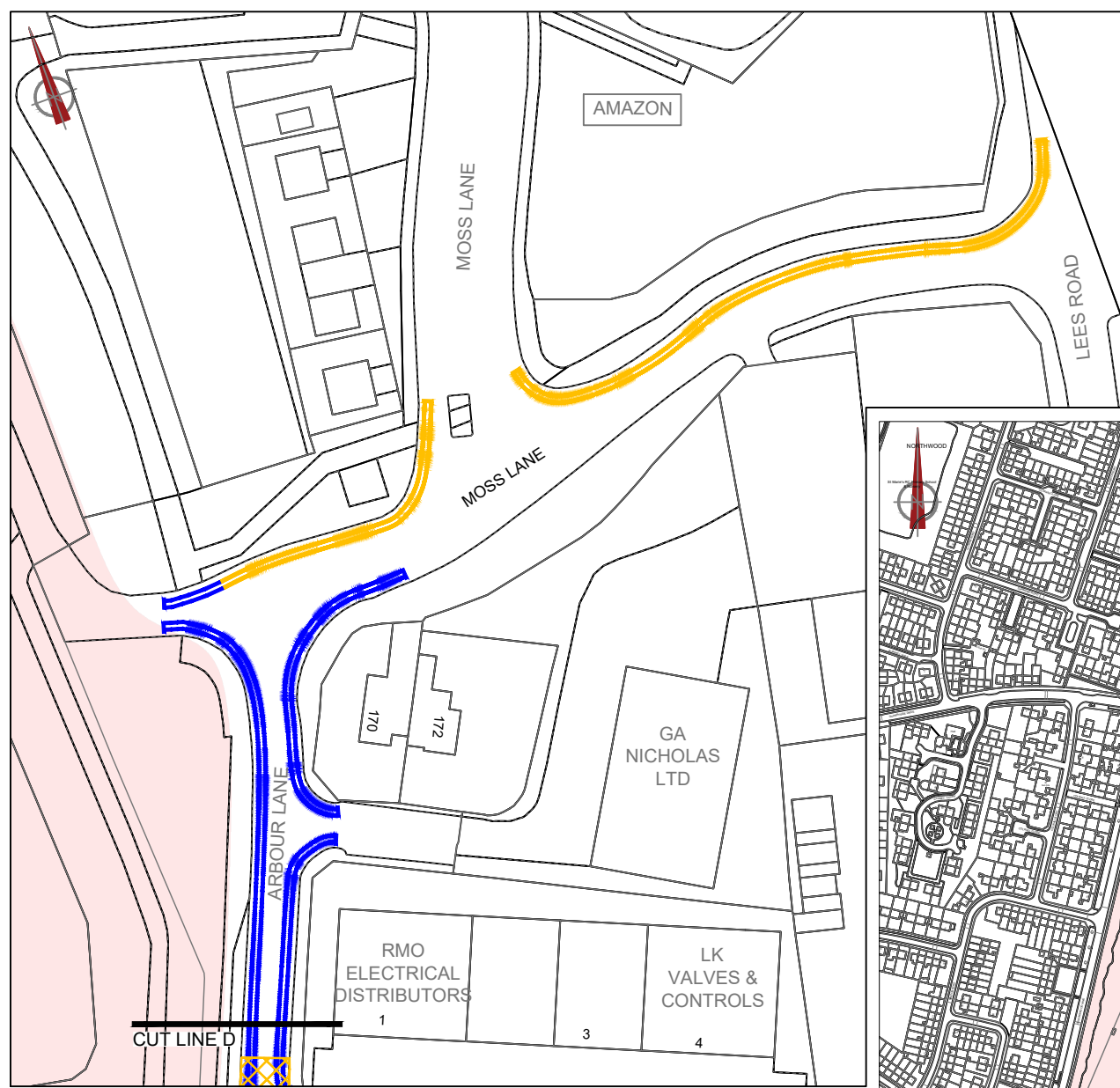

VIEWPORT 5

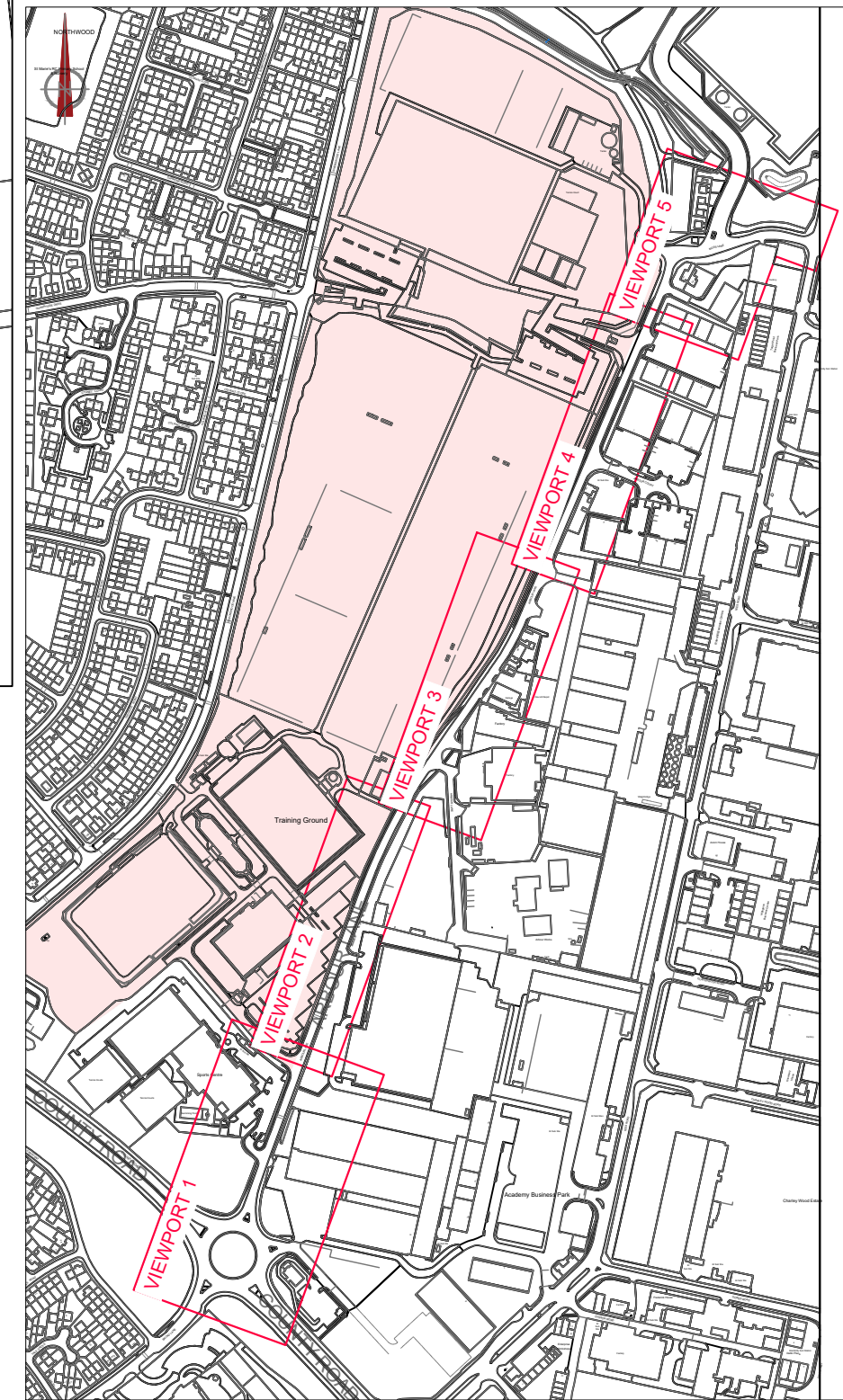





LOCATION PLAN

NOTES:

No reproductions without Authority
 Do not scale, use only figured dimensions.
 The contractor is to check all dimensions on site and report any discrepancies to the Project Manager or Site Supervisor.
 This drawing is to be read in conjunction with all other standard documentation.
 Ordnance Survey material produced with permission under Knowsley Metropolitan Borough Council Crown Copyright OS licence number 100022848, 2023.

KEY

-  EXISTING DOUBLE YELLOW LINES (NO WAITING AT ANY TIME) TO REMAIN
-  PROPOSED DOUBLE YELLOW LINES (NO WAITING AT ANY TIME)
-  PROPOSED YELLOW BOX JUNCTION MARKING
-  LFC TRAINING GROUND SITE EXTENTS

REV	DESCRIPTION	BY	DATE
STATUS: FOR CONSULTATION			



Knowsley Council

HIGHWAYS & CAPITAL DELIVERY NETWORK MANAGEMENT
 PO Box 21 | Archway Road | Huyton | L36 9YU
 www.knowsley.gov.uk

ARBOUR LANE, KIRKBY	
PROJECT NAME: PROPOSED WAITING RESTRICTIONS	
PROJECT NAME: PT/TM/7872/02	
DRAWING NUMBER: 0	REV: 0

LT	CHECKED:	APPROVED:	1:1000
MAY 24	DATE:	DATE:	
SCALE @A3:			